



## STATE OF THE ART FEATURES

- Part of 8-Building Master-planned Industrial Park
- ±2,500 SF Finished Ground Floor Office Suites with ±2,500 SF Mezzanine
- 5 Dock High Loading Doors
- 1 Grade Level Loading Door
- 30' Clear Height
- Fenced and Secured Concrete Truck Yards
- ESFR Fire Sprinkler System
- 1,200 Amp UGPS with 800 Amp House Panel
- 4-ply Built-Up Roof with 15-yr NDL Warranty
- 2.5% Skylights
- White Scrim Insulation
- Close Proximity to Ontario International Airport
- Great Access to I-10, Hwy 60, Hwy 71, and I-15 Freeways

# OAKMONT MONTCLAIR INDUSTRIAL PARK

## BUILDING 4 ±37,143 SF

*For More Information, please contact:*

**MARK KEGANS, SIOR**  
909.974.4070  
mark.kegans@nrmk.com  
CA RE Lic #00866145

**RANDY LOCKHART**  
909.974.4067  
randy.lockhart@nrmk.com  
CA RE Lic #00974981

**RON WASHLE, SIOR**  
909.974.4071  
ron.washle@nrmk.com  
CA RE Lic #00978222

**STEVE SPRENGER**  
909.974.4078  
steve.sprenger@nrmk.com  
CA RE Lic #01202806

**NEWMARK**

**OAKMONT**  
INDUSTRIAL GROUP

# OAKMONT MONTCLAIR INDUSTRIAL PARK

Northwest Corner of Mission Blvd & Ramona Ave | Montclair, CA

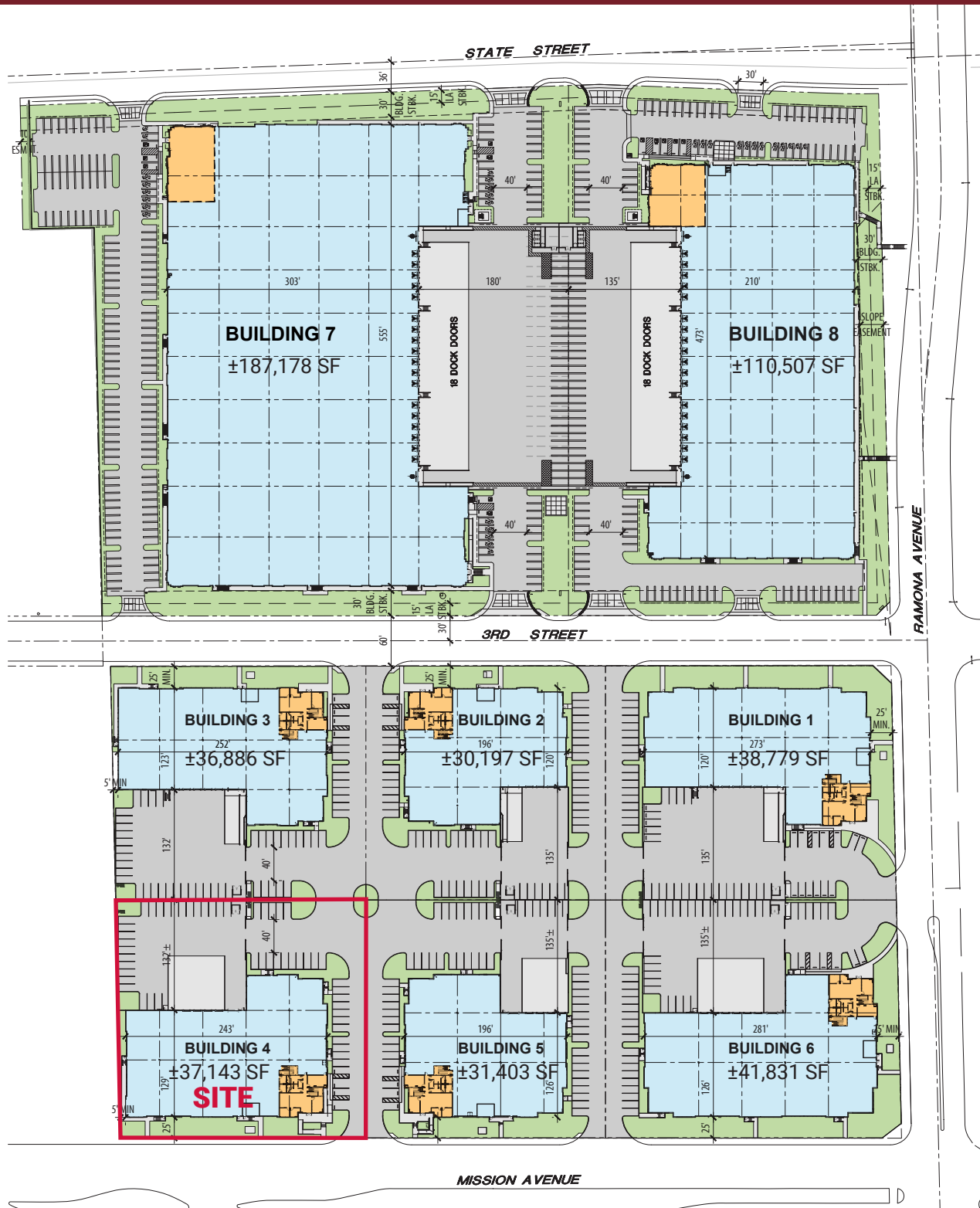

For more information, please contact:

**MARK KEGANS, SIOR**  
 909.974.4070  
 mark.kegans@nrmk.com  
 CA RE Lic #00866145

**RON WASHLE, SIOR**  
 909.974.4071  
 ron.washle@nrmk.com  
 CA RE Lic #00978222

**RANDY LOCKHART**  
 909.974.4067  
 randy.lockhart@nrmk.com  
 CA RE Lic #00974981

**STEVE SPRENGER**  
 909.974.4078  
 steve.sprenger@nrmk.com  
 CA RE Lic #01202806

3281 East Guasti Road, Suite 600 | Ontario, CA 91761 | Corporate RE Lic. #01355491 | [www.nrmk.com](http://www.nrmk.com)  
 Although all information furnished regarding property for sale, rental, or financing is from sources deemed reliable, such information has not been verified and no express representation is made nor is any to be implied as to the accuracy thereof and it is submitted subject to errors, omissions, change of price, rental or other conditions, prior sale, lease or financing, or withdrawal without notice and to any special conditions imposed by our principal.