



**FOR SUBLEASE**

# 2851 E Las Hermanas

Rancho Dominguez, CA 90058

## 98,985 SF Industrial For Sublease

### Highlights:

- Transloading Facility - 46 Positions\*
- 195' Loading Distance - Container Parking
- Excess Trailer/ Container Parking
- Two Street Access With Drive Around Access
- Securely Fenced And Lit Concrete Yard
- Unincorporated LA County
- Sublease through 11/30/26

### Building:

- 98,985 SF
- 11,735 SF Office Space
- 21' Clear Height
- 30 DH, 1 GL Loading Doors
- 800 Amps
- Sprinklers
- Secured Truck Yard Area
- 75 Car Parking Spaces

### Contact Us:



**Jeff Smart**  
Senior Executive Vice President  
CA Lic. 00918873  
+1 310 321 1812  
jeffrey.smart@colliers.com

**Elizabeth Capati**  
Senior Associate  
CA Lic. 02109628  
+1 310 321 1855  
elizabeth.capati@colliers.com



**Steve Sprenger**  
Vice Chairman  
CA. Lic. 01202806  
+1 714 264 3993  
steve.sprenger@nrmk.com

2851 E Las Hermanas

# Site Plan

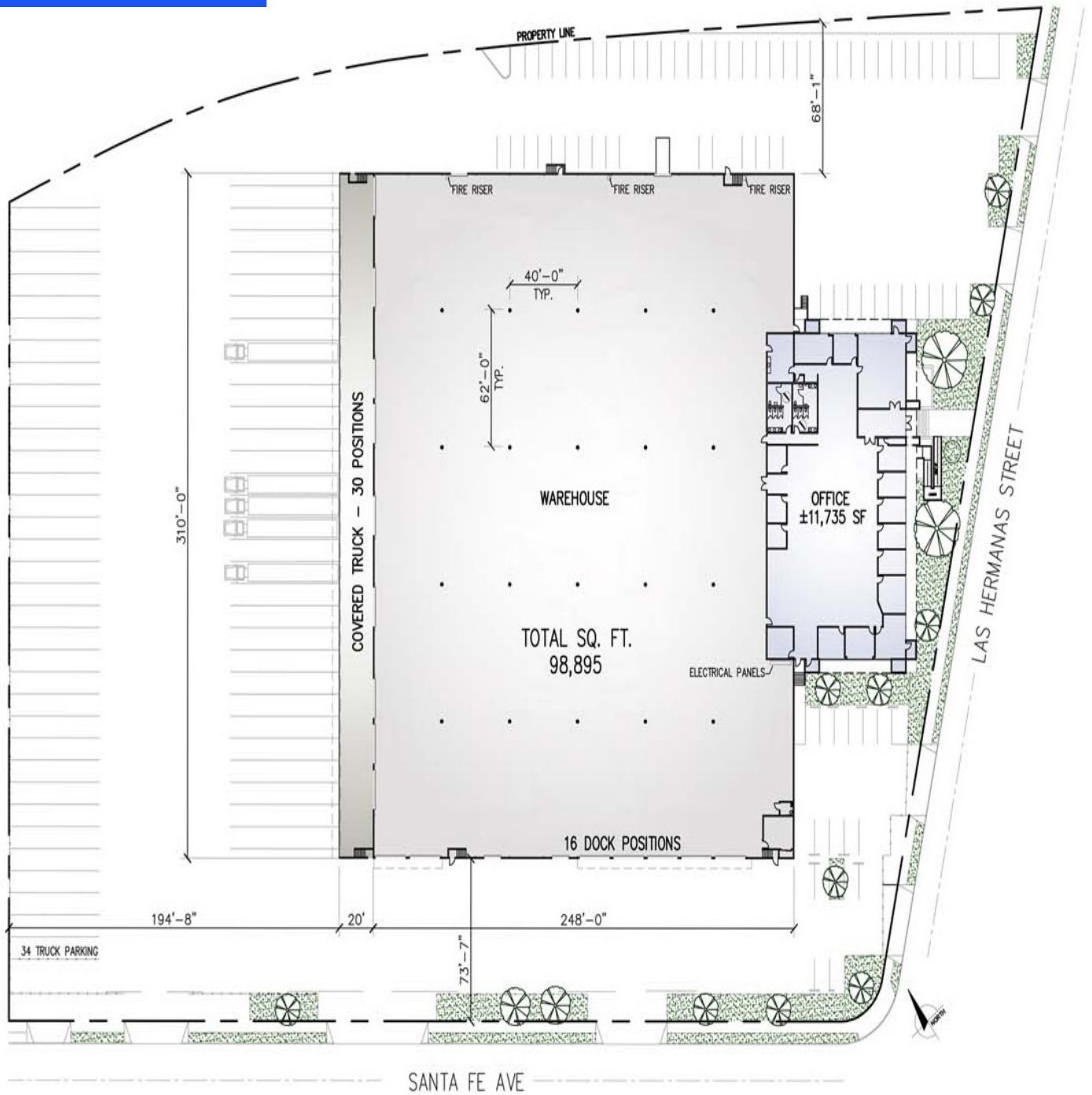

## CONTACT US



**Jeff Smart**  
Senior Executive Vice President  
CA Lic. 00918873  
+1 310 321 1812  
jeffrey.smart@colliers.com

**Elizabeth Capati**  
Senior Associate  
CA Lic. 02109628  
+1 310 321 1855  
elizabeth.capati@colliers.com



**Steve Sprenger**  
Vice Chairman  
CA. Lic. 01202806  
+1 714 264 3993  
steve.sprenger@nrmk.com